

- NOTES:
- 1. MATERIAL: ABS
 - 2. FINISH: BODY/COVER - GRAY
 - 3. RoHS COMPLIANT
 - 4. CONTINUOUS GASKET IN COVER
 - 5. -20 °C TO +65 °C EXTENDED EXPOSURE CONDITION
 - 6. SUPPLIED WITH TWO M4 x 8mm LG. TRUSS HEAD MACHINE SCREWS
 - 7. DIMENSIONS ARE INCH [MM]
 - 8. OPTIONAL ACCESSORIES:
INTERNAL STEEL PANEL - #PTX-25311
INTERNAL PLASTIC PANEL - #PTX-25311-P
MOUNTING BRACKET KIT (STAINLESS STEEL) - #NBX-10920

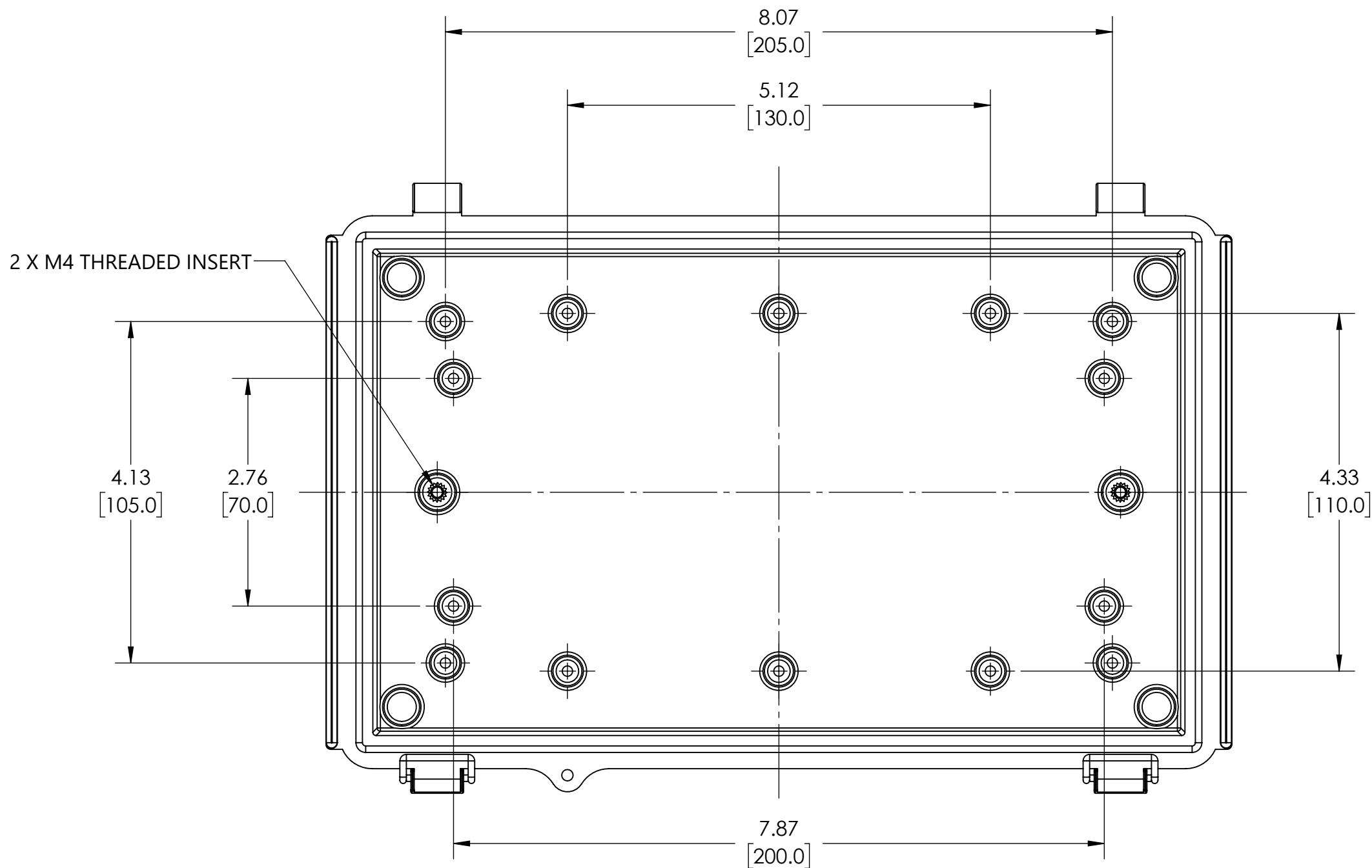

INSIDE VIEW OF BODY

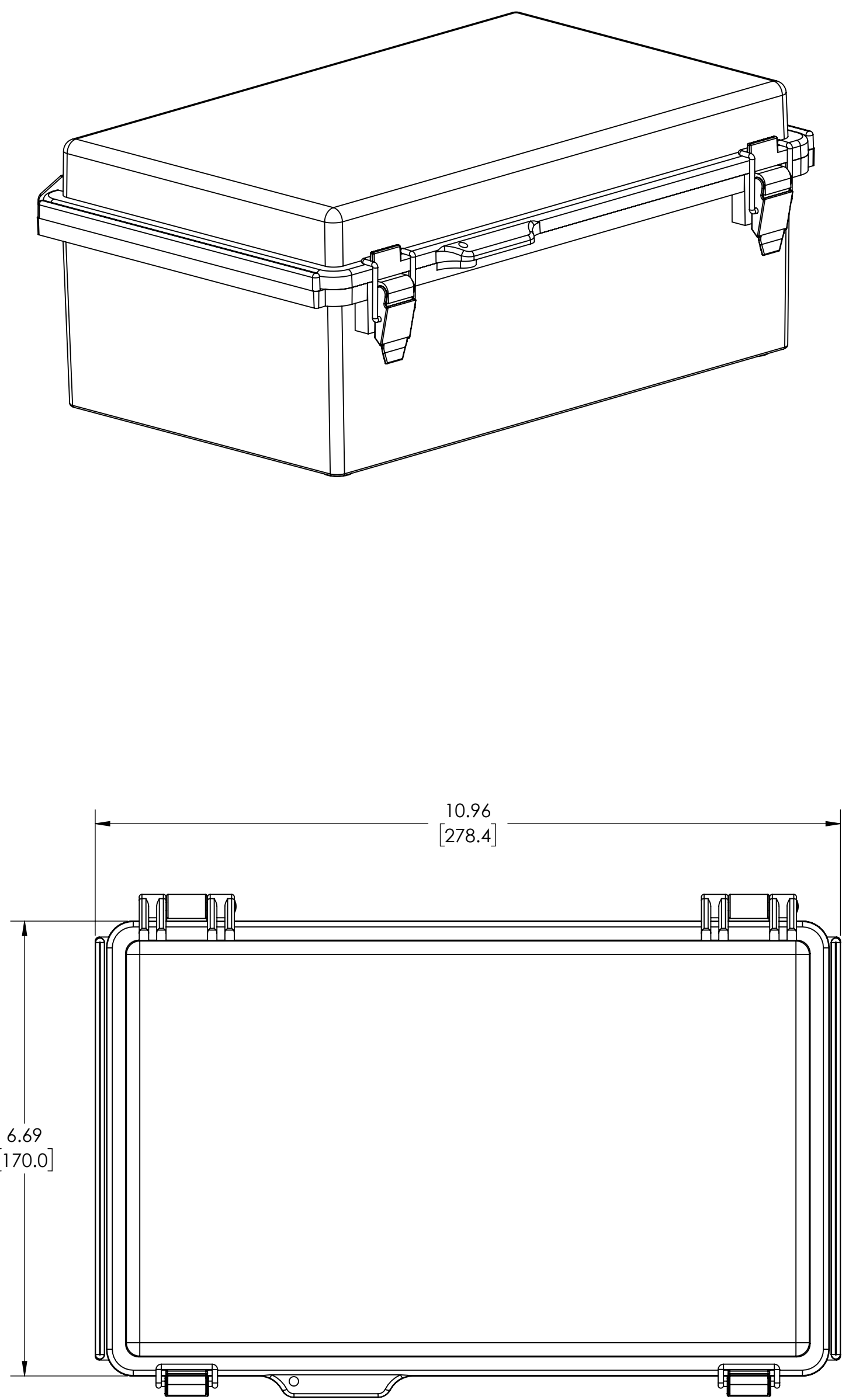
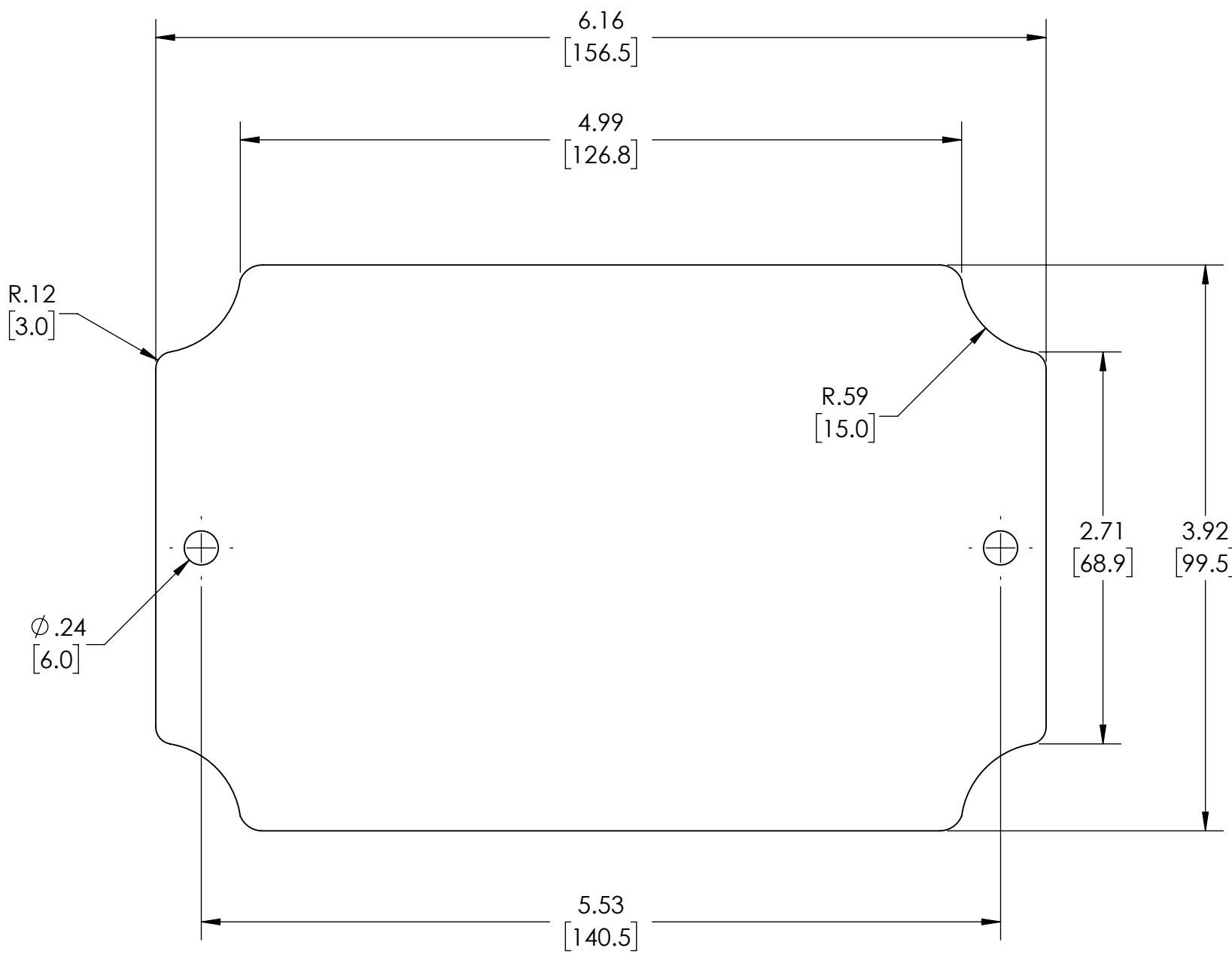

OPTIONAL INTERNAL PANEL AND SUGGESTED PC BOARD LAYOUT

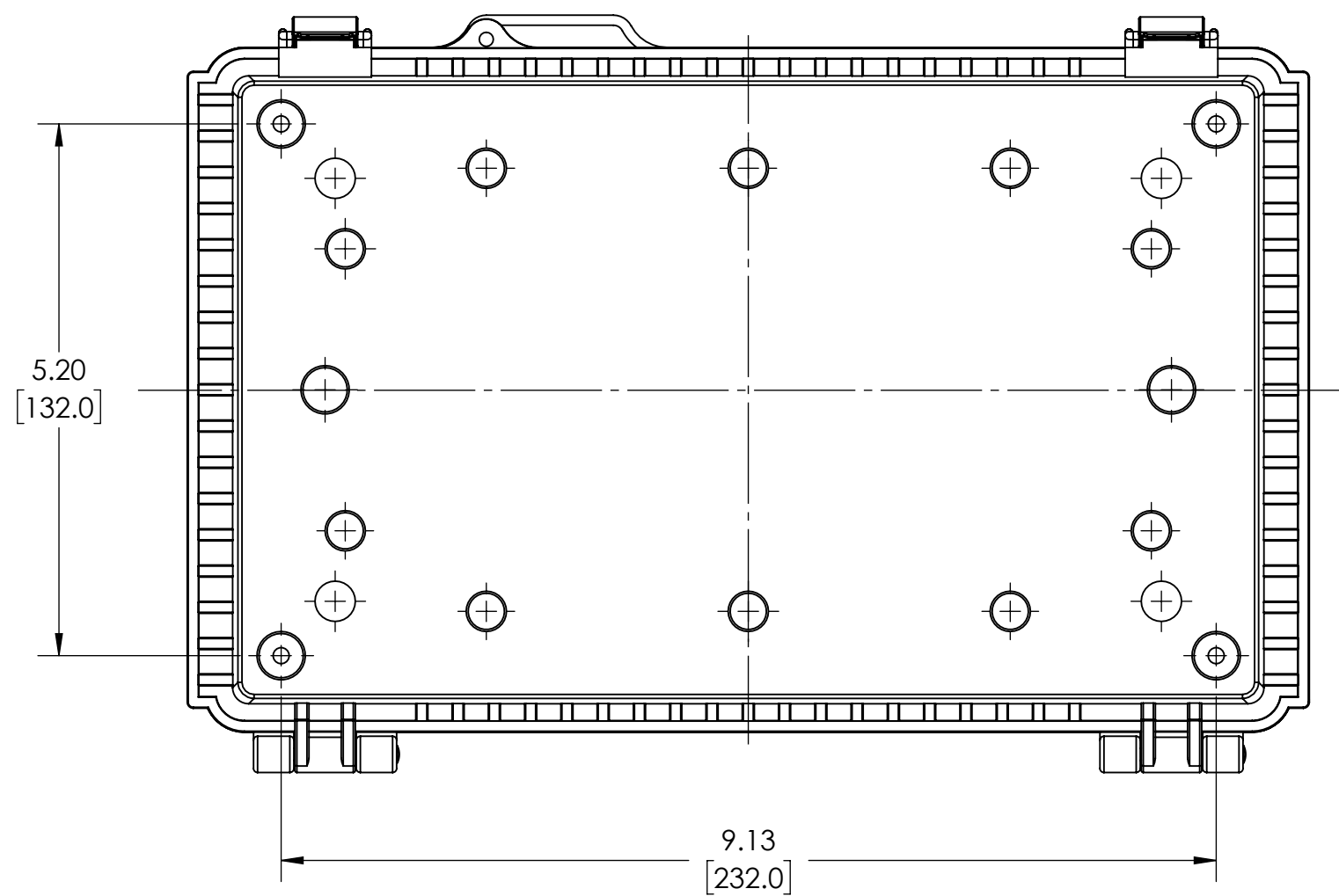

BOTTOM VIEW

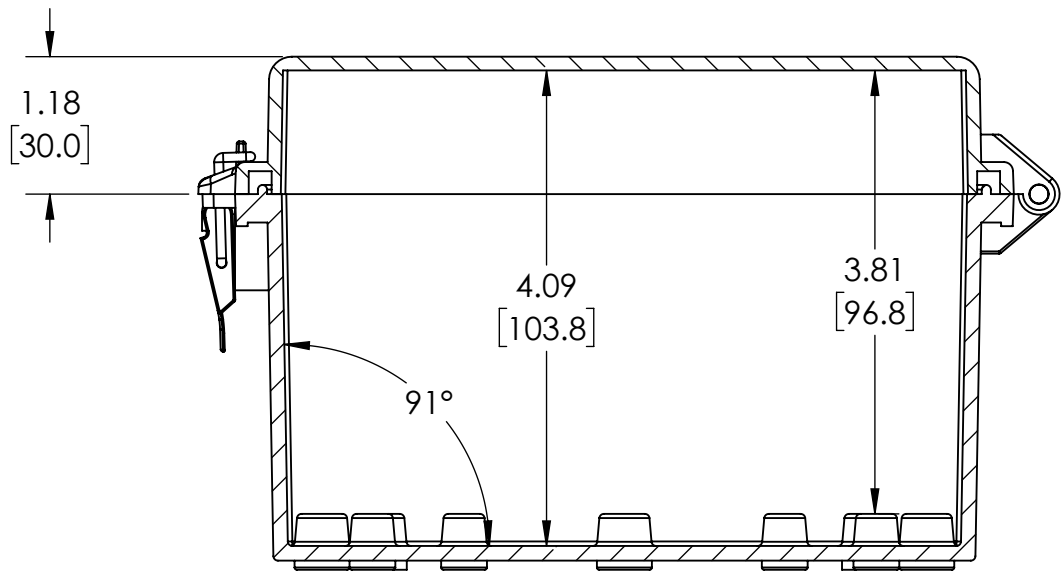
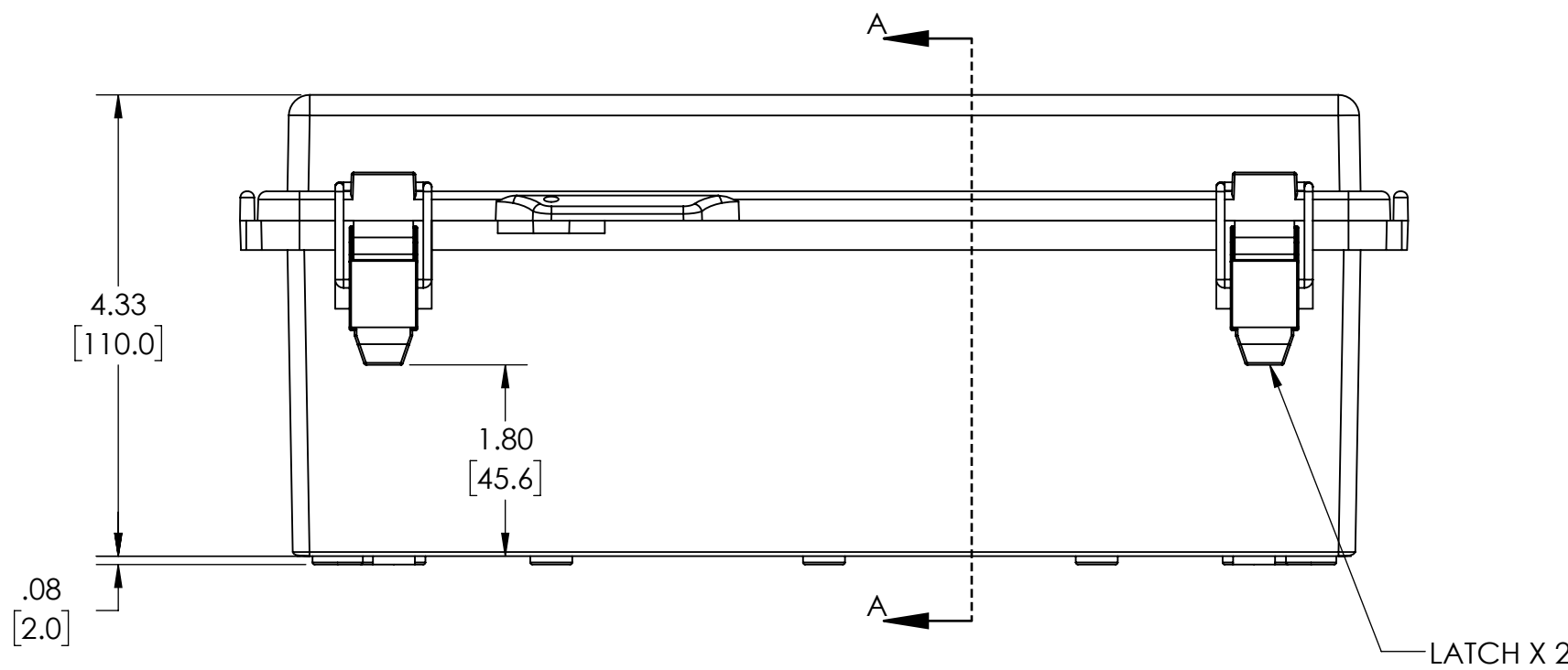

SECTION A-A

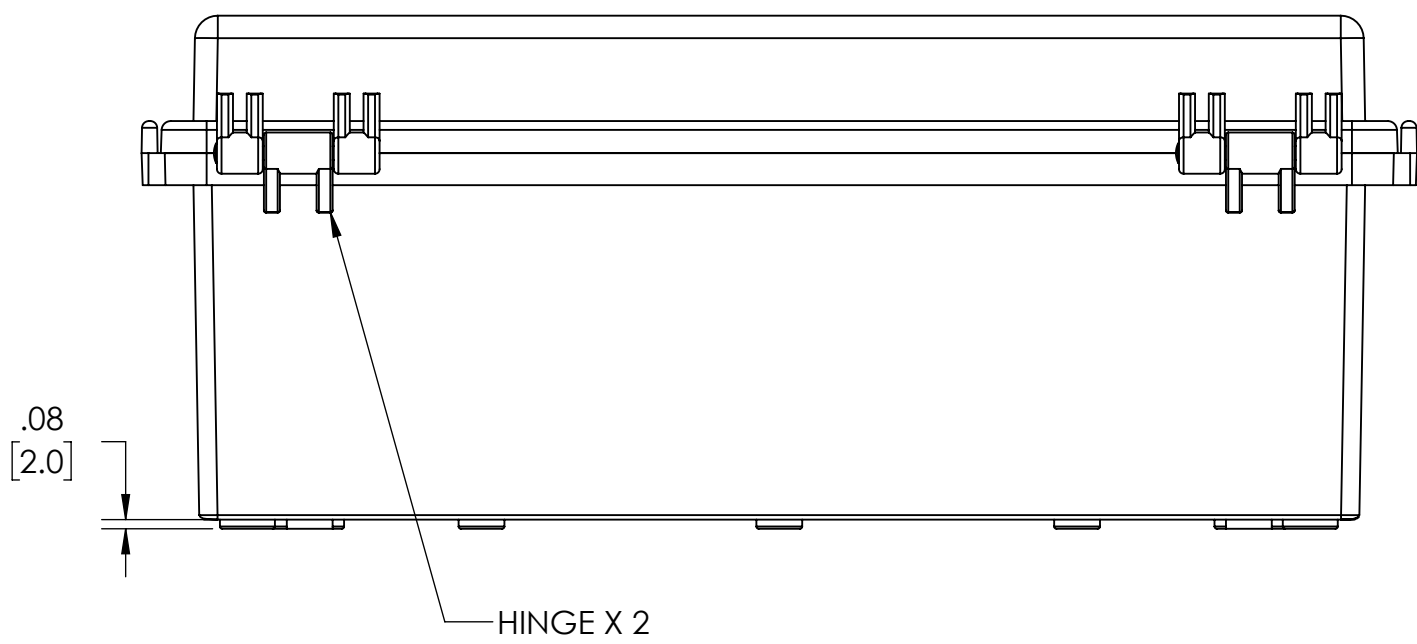

DRAWING FOR REFERENCE
WE RESERVE THE RIGHT TO MAKE CHANGES TO OUR
STANDARD PRODUCTS. PLEASE CONSULT WITH BUD INDUSTRIES
PRIOR TO USING THIS DRAWING FOR DESIGN PURPOSE.